

TRAILER HITCH MOUNTING INSTRUCTIONS

CATALOG NUMBER 247392

APPLICATION

HITCH CAPACITY 2000 pounds gross trailer weight 200 pounds maximum tongue load OR the maximum load specified by the vehicle manufacturer; WHICHEVER IS LESS.

- NOTES: A. This hitch features a removable ball mount. This hitch is not intended for use as a weight distributing hitch. Before towing, the hitch pin and retainer clip MUST be in place securing ball mount to receiver.
B. This product complies with safety specifications and requirements for connecting devices and towing systems of the state of New York and regulation V.E.S.C. V-5.

1. General Fit: This hitch mounts at tie-down bracket frame points (driver's side) and to the side of the spare tire well (passenger side) inboard of the muffler. No fascia trimming or bumper removal is necessary.
2. Preparation: Clear trunk and temporarily remove spare tire. Temporarily lower muffler by unfastening rearmost bracket (2 nuts) and support muffler. Temporarily remove heat shield (4 nuts). On driver's side, remove the tie-down bracket (3 12mm screws). Plastic panel at bracket may be temporarily removed for access. Disconnect two tabs at fascia bottom connecting fascia to body.
3. Position hitch up under fascia between fascia and body bringing two fascia tabs down under hitch to be re-connected. On driver's side, mount hitch at two tie-down points using fasteners ①. Do not fully tighten.
4. Position opposite hitch bracket on tire well checking hitch to be level and bracket holes best position on well ribs. Drill tire well four places for 3/8" diameter screws. Access for drilling should be above muffler.
5. At forwardmost bracket hole, install fastener ② as shown placing screw from OUTSIDE the car. At other holes install fasteners ③ from OUTSIDE the car; all washers and nuts fitting INSIDE. At rearmost hole one spacer # 517 is provided to fill tire well/bracket space. Spare tire may have to be shifted slightly to left in well for clearance.
6. Final tighten fasteners as specified on reverse of these instructions. Replace heat shield and form as necessary for muffler clearance. Replace all items in step 2 except tie down bracket; return to car's owner.

FASTENERS:

- ① (2) 12x 1.25x 40mm screws
(2) 7/16" flat washers
(2) 1/2" lock washers
- ② (1) 3/8x 1" screws
(1) 3/8" fender washers
(1) 3/8" lock washers
(1) 3/8" hex nut
- ③ (3) 3/8x 1 1/4" screws
(3) 3/8" fender washers
(3) 3/8" lock washers
(3) 3/8" hex nuts
(1) spacer # 1-3-517
1 1/2 x 2 1/2

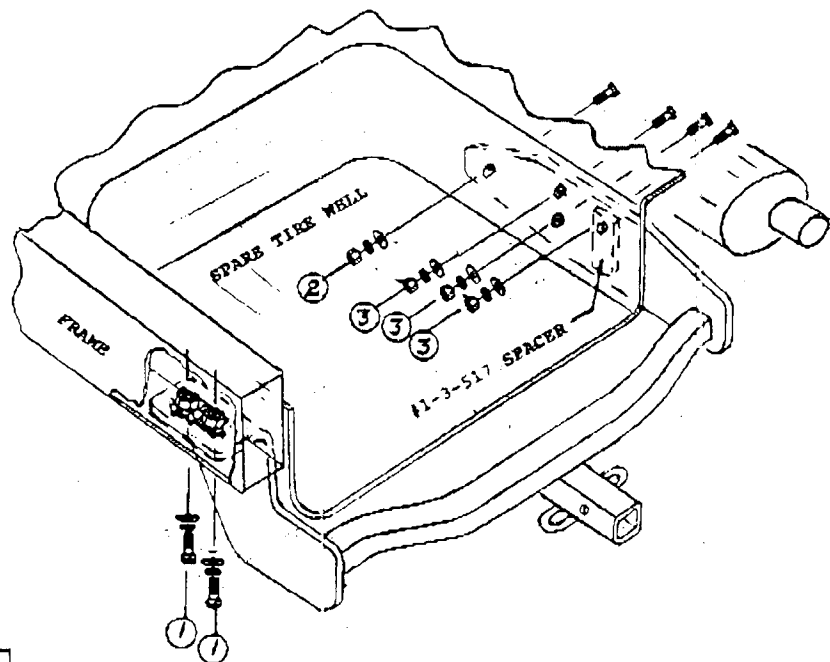

DATE: 01/12/01 A

USE BALL MOUNT: #55040

CAUTION: Hitch will accommodate 2 place (max.) bike racks. Available stabilizing cord MUST be used between rack and vehicle