

# INSTALLATION INSTRUCTIONS

EQUIPMENT REQUIRED:

WIRING ACCESS LOCATION: PU1, PU2

DRILL BITS: 1/2"

HITCH REQUIRES 5/8" PIN AND CLIP IF STABILIZING PIN (7651) IS NOT INSTALLED.

WRENCHES: (TIGHTEN ALL FASTENERS WITH TORQUE WRENCH) 3/4, 7/8

TORQUE WRENCH

DO NOT EXCEED LOWER OF  
TOWING VEHICLE MFR'S RATINGS OR

HITCH TYPE ▼	MAX GROSS TRLR WT(LB)	MAX TONGUE WT(LB)
WEIGHT DISTRIBUTING	10,000	1000
WEIGHT CARRYING BALL MOUNT	5000	500

NOTE: FASTENERS TYPICAL FOR ALL HOLES

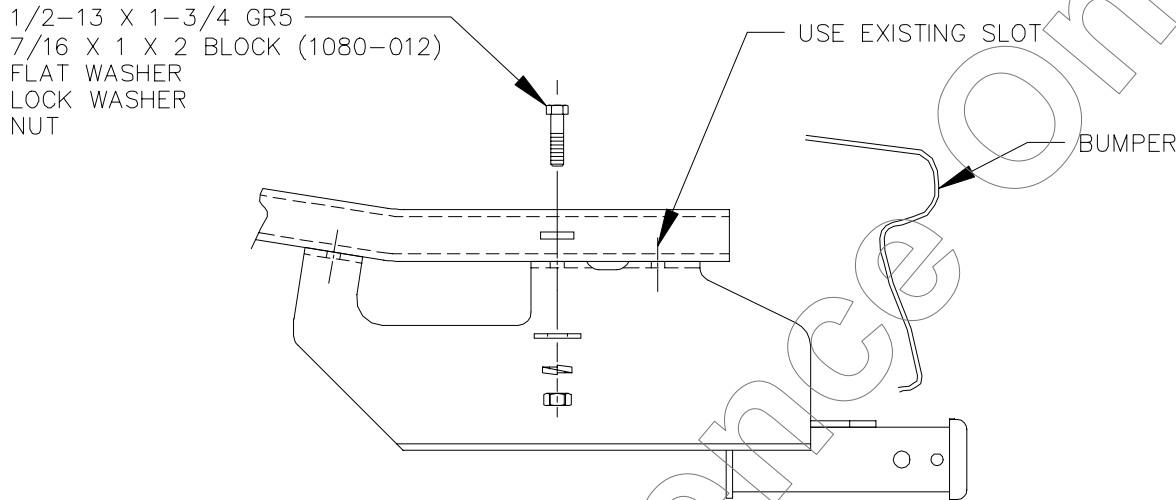

## OPTIONAL LOCKING STABILIZING PIN

J-PIN

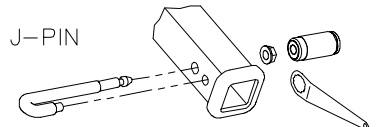

Part No. 7651 (Order Separately)

1. REMOVE SPARE TIRE AND CARRIER FROM VEHICLE.
2. TO RETAIN UNDER -BOX STOWAGE, THE SPARE TIRE CARRIER WILL HAVE TO BE RELOCATED AND/OR MODIFIED. LARGER TIRES MAY NOT FIT BETWEEN REAR AXLE AND RECEIVER CROSSTUBE.
3. POSITION RECEIVER ON VEHICLE AS SHOWN. LINE UP FIRST HOLE IN SIDE BRACKET OF RECEIVER WITH SLOT IN FRAME RAIL. THE LENGTH OF THIS SLOT IS PARALLEL TO THE LENGTH OF FRAME. SOME PICKUP FRAMES WILL HAVE A 3/8" DIAMETER HOLE WHICH LINES UP WITH THE SECOND HOLE IN THE SIDE BRACKET OF THE RECEIVER. REAM OUT THIS HOLE USING 1/2" DRILL BIT.
4. USING RECEIVER AS A TEMPLATE, DRILL REMAINING HOLES IN BOTTOM OF FRAME WITH 1/2" DRILL BIT.
5. INSTALL AND TIGHTEN ALL FASTENERS AS SHOWN, PLACING BLOCKS INSIDE VEHICLE FRAME : TIGHTEN 1/2-13 GR5 BOLTS TO 75 LB-FT.

THIS PRODUCT COMPLIES WITH SAFETY SPECIFICATIONS AND REQUIREMENTS FOR CONNECTING DEVICES AND TOWING SYSTEMS OF THE STATE OF NEW YORK AND V.E.S.C. REGULATION V-5.

APPROX WEIGHT (LB.)	51.3	FASTENER KIT NO.	K41003
---------------------	------	------------------	--------

NOTE: Check hitch frequently, making sure all fasteners and ball are properly tightened. If hitch is removed, plug all holes in trunk pan or other body panels to prevent entry of water and exhaust fumes. A hitch or ball which has been damaged should be removed and replaced. Observe safety precautions when working beneath a vehicle and wear eye protection. Follow car maker's specs for maximum trailer weight and tongue weight. Do not cut access or attachment holes with a torch.