

INSTALLATION INSTRUCTIONS

EQUIPMENT REQUIRED:

DRILL BITS: 1/2

WRENCHES: (TIGHTEN ALL FASTENERS WITH TORQUE WRENCH) 9/16, 10mm, 13mm, 15mm

VEHICLE	HITCH NO.
OLDSMOBILE LSS OLDSMOBILE 88 PONTIAC BONNEVILLE (ALL MODELS EXCEPT SSE, SSEi AND SLE)	36211

3500 LB MAX GROSS TRAILER WT
300 LB MAX TONGUE WEIGHT
DO NOT EXCEED TOWING VEHICLE RATINGS

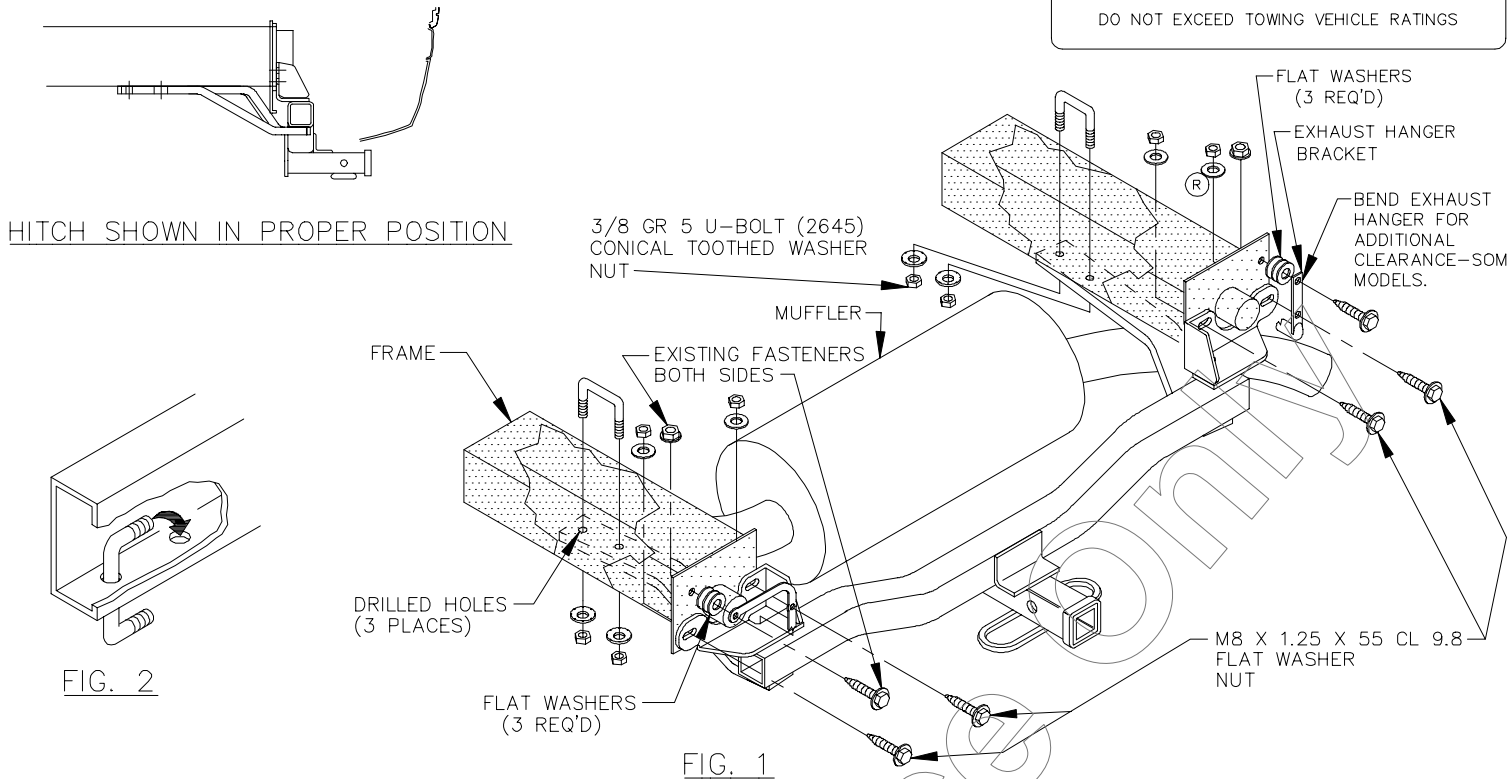

TIGHTEN U-BOLTS EVENLY WITH HAND TORQUE WRENCH. DO NOT USE IMPACT WRENCH.

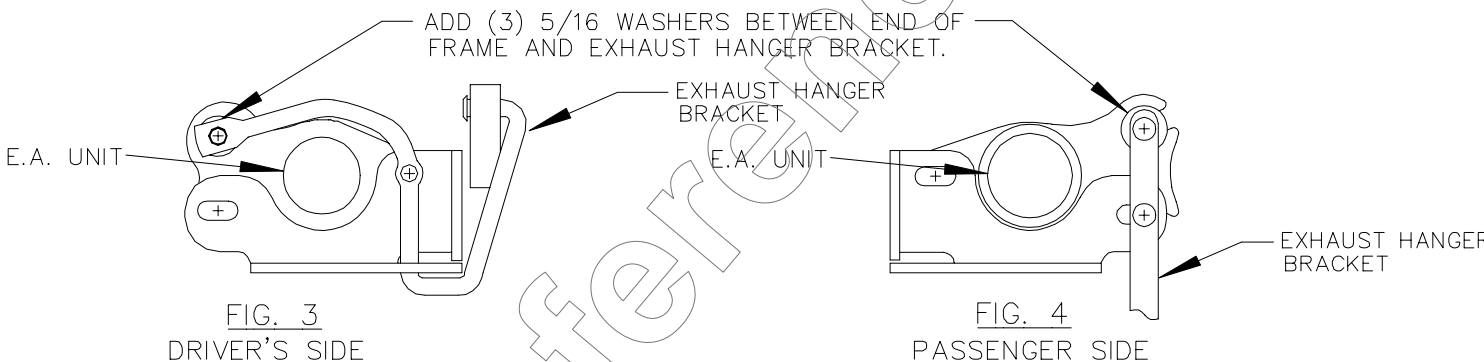

1. REMOVE INBOARD AND LOWER OUTBOARD ENERGY ABSORBER (E/A) UNIT MOUNTING BOLTS FROM BOTH SIDES OF FRAME. REMOVE THE UPPER OUTBOARD BOLT THAT ATTACHES THE EXHAUST HANGER BRACKET TO END OF THE FRAME ON DRIVER'S AND PASSENGER SIDE.
2. POSITION THE HITCH ON THE VEHICLE AS SHOWN AND LOOSELY INSTALL THE M8 BOLTS PROVIDED. USE THE HITCH SIDE ARMS AS A TEMPLATE TO DRILL FOUR (4) 1/2" HOLES.
NOTE: THE SIDE ARMS MUST SIT FLAT AGAINST THE VEHICLE FRAME. CHISEL OR DRILL OUT RIVETS HOLDING HEAT SHIELD UNDER SIDE ARMS IF REQUIRED. ALSO, BEND HEAT SHIELD IF NEEDED.
3. LOWER SIDE ARMS AND INSERT THE 3/8 U-BOLTS THROUGH THE FRAME AS SHOWN IN FIG. 2. RAISE SIDE ARMS INTO POSITION AND INSTALL THE 3/8 CONICAL WASHERS AND NUTS ON THE U-BOLTS.
NOTE: DRIVER'S SIDE EXHAUST HANGER BRACKET MUST BE REATTACHED THROUGH THE OPENING IN THE HITCH UPRIGHT BEFORE REATTACHING SHOULDER BOLT AS SHOWN IN FIG. 3.
THIS WILL REQUIRE WASHERS TO BE USED AS SPACERS BETWEEN THE BRACKET AND VEHICLE. SEE FIGS. 3 & 4.
4. USE THREE (3) 5/16 FLAT WASHERS PROVIDED TO SHIM SPACE BETWEEN EXHAUST BRACKET AND THE UPPER OUTBOARD ATTACHMENT FOR E/A UNIT ON DRIVER'S AND PASSENGER SIDE. USE EXISTING FASTENERS TO REATTACH EXHAUST HANGER BRACKET, SEE FIG 3 AND 4. DEFORMATION OF SHEET METAL FLANGES ON E/A MOUNTING SURFACES IS PERMISSIBLE WHEN FASTENERS ARE TIGHTENED.
5. SOME MODELS MAY REQUIRE BENDING EXHAUST HANGER ON PASSENGER SIDE FOR REQUIRED CLEARANCE.

TIGHTEN M8 CL9.8 FASTENERS TO 25 LB.-FT.
TIGHTEN 3/8 GR5 FASTENERS TO 31 LB.-FT.

PONTIAC BONNEVILLE

COMPLETE HITCH INCLUDES
PIN 2210
CLIP 2209

36013 ZINC DRAWBAR OR 36014 CHROME

DRAWBAR REPLACEMENT KIT (INCLUDES PIN & CLIP)
36063 ZINC
36064 CHROME

NOTE: REPLACEMENT DRAWBAR AVAILABLE ONLY IN KIT. PINS & CLIPS AVAILABLE SEPARATELY.

OLDSMOBILE 88 & LSS

COMPLETE HITCH INCLUDES
PIN 2210
CLIP 2209

36011 ZINC DRAWBAR 36012 CHROME

DRAWBAR REPLACEMENT KIT (INCLUDES PIN & CLIP)
36061 ZINC
36062 CHROME

NOTE: REPLACEMENT DRAWBAR AVAILABLE ONLY IN KIT. PINS & CLIPS AVAILABLE SEPARATELY.

USE ONLY THE DRAWBAR SHOWN FOR CORRECT BUMPER CLEARANCE AND HEIGHT.
REMOVE DRAWBAR WHEN NOT TOWING
TO PROTECT DRAWBAR OPENING IN HITCH WHEN NOT TOWING, INSERT COVER #2211 (PURCHASED SEPARATELY).

THIS PRODUCT COMPLIES WITH SAFETY SPECIFICATIONS AND REQUIREMENTS FOR CONNECTING DEVICES AND TOWING SYSTEMS OF THE STATE OF NEW YORK AND V.E.S.C. REGULATION V-5.

APPROX WEIGHT (LB.)	FASTENER KIT NO.
33	1130-937

NOTE: Check hitch frequently, making sure all fasteners and ball are properly tightened. If hitch is removed, plug all holes in trunk pan or other body panels to prevent entry of water and exhaust fumes. A hitch or ball which has been damaged should be removed and replaced. Observe safety precautions when working beneath a vehicle and wear eye protection. Follow car maker's specs for maximum trailer weight and tongue weight. Do not cut access or attachment holes with a torch.