

24679

1998 - 2010 VOLKSWAGEN BEETLE INCLUDING CONVERTIBLE (Except Turbo)  
1999 1/4 - 2006 VOLKSWAGEN GOLF HATCHBACK (Except VR6, R32 & 4-MOTION)  
1999 1/4 - 2005 VOLKSWAGEN GTI COUPE  
2007 - 2009 VOLKSWAGEN CITY GOLF (CANADIAN ONLY)

2/15/2010

GROSS LOAD CAPACITY WHEN USED AS A WEIGHT CARRYING HITCH: 2,000 LBS. TRAILER WEIGHT & 200 LBS. TONGUE WEIGHT.

\*\*\*DO NOT EXCEED VEHICLE MANUFACTURER'S RECOMMENDED TOWING CAPACITY.\*\*\*

WARNING: ALL NON-TRAILER LOADS APPLIED TO THIS PRODUCT MUST BE SUPPORTED BY AUXILIARY STABILIZING STRAPS.

\*\* FAILURE TO PROPERLY SUPPORT NON-TRAILER LOADS WILL VOID PRODUCT WARRANTY\*\*

HAVING INSTALLATION QUESTIONS? CALL TECHNICAL SUPPORT AT 1-800-798-0813

Parts List			
ITEM	QTY	PART NUMBER	DESCRIPTION
1	1	1/2-13	HANDLE NUT
2	1	1/2"	CONICAL TOOTHED WASHER
3	1	1/2"	WASHER
4	5	3/8 - 16 x 1 1/4	HEX BOLT
5	1	CM-SP52	.500 x 1.25 x 2.50" ROUND HOLE SPACER
6	1	1/2-13 x 1 1/4	HEX BOLT
7	6	3/8"	FENDER WASHER
8	6	HFN3816	HEX FLANGE NUT
9	1	3/8 - 16 x 1 3/4	HEX BOLT

#### RUBBER ISOLATOR REMOVAL DIAGRAM

This technique can be used if and Exhaust Hanger Removal Pliers is not available.

Using a 5/8" open end wrench, slide the wrench up to the rubber isolator, cradling the hanger rod as shown. Next place the flat edge of a pry bar between the wrench and the hanger stop or hanger rod. Then simply rotate the pry bar toward the wrench to remove the rubber isolator.

Note: Using a spray lubricant or soapy water on the hanger rod and the rubber isolator helps removal.

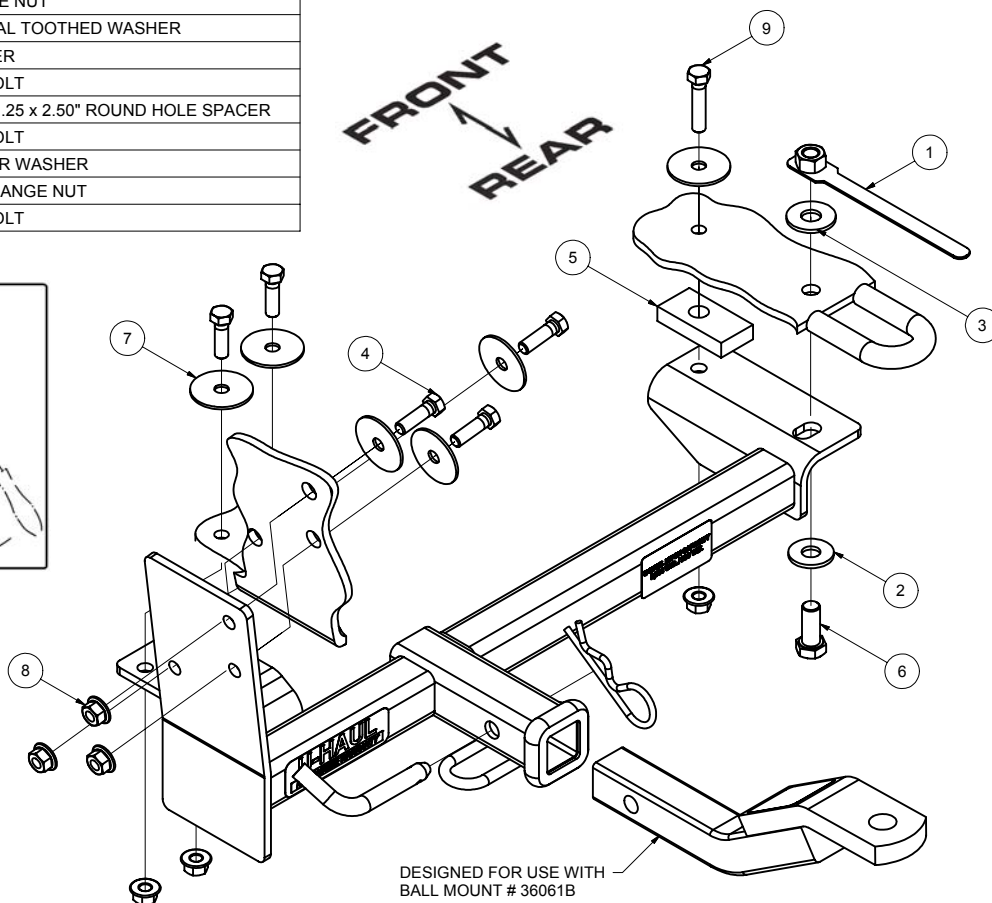
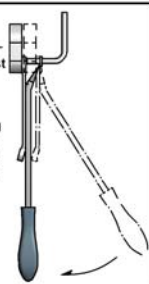

HITCH WEIGHT: 18 LBS.

#### INSTALL TIME

PROFESSIONAL: 20 MINUTES

NOVICE (DIY): 40 MINUTES

#### INSTALL NOTES:

- TEMPORARILY REMOVE SPARE
- LOWER EXHAUST
- DRILLING REQUIRED

## INSTALLATION STEPS

- 1) Temporarily remove spare tire and lower exhaust to ease installation.
- 2) BEETLE ONLY: Lift hitch into position, aligning the slot on the passenger side plate with the second hole back from the tie down loop opening. Loosely install fasteners as shown.
- 3) GOLF ONLY: Align edge of passenger side bracket with opening of tie-down loop bracket. Use oval hole of right side bracket as a template and drill a hole for 1/2" fastener. Install fasteners as shown; cut handle off handle nut if needed.
- 4) With hitch in position and square on car, use hitch as a drill template and drill two holes in bottom of tire well. Install fasteners as shown. Using the hitch as a drill template, drill three holes on the side of the tire well and install fasteners as shown.
- 5) Torque all 1/2" hardware to 75 lb.-ft. and all 3/8" hardware to 30 lb.-ft.

**PERIODICALLY CHECK THIS RECEIVER HITCH TO ENSURE THAT ALL FASTENERS ARE TIGHT AND THAT ALL STRUCTURAL COMPONENTS ARE SOUND.**