

36289

BUICK LE SABRE- ALL MODELS
PONTIAC BONNEVILLE- ALL MODELS, OLDSMOBILE AURORA

GROSS LOAD CAPACITY WHEN USED AS A WEIGHT CARRYING HITCH: 3,500 LBS. TRAILER WEIGHT & 350 LBS. TONGUE WEIGHT.
DO NOT EXCEED VEHICLE MANUFACTURER'S RECOMMENDED TOWING CAPACITY.

Parts List			
ITEM	QTY	PART NUMBER	DESCRIPTION
1	1	1/2"	FISHWIRE TOOL
2	2	1/2 - 13 x 1 3/4	CARRIAGE BOLT
3	2	1/2 - 13	HEX FLANGE NUT
4	2	3/8-16 x 2	CARRIAGE BOLT
5	2	3/8-16	HEX FLANGE NUT
6	2	M10 - 1.5 x 45mm	HEX BOLT
7	2	3/8"	CONICAL TOOTHED WASHER
8	2	CM-SP6	.250 x 1.00 x 3.00" SQUARE HOLE SPACER
9	2	CM-12044-EHB	.250" EXHAUST HANGER BRACKET

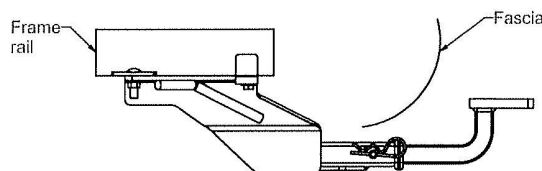

HITCH SHOWN PROPERLY INSTALLED

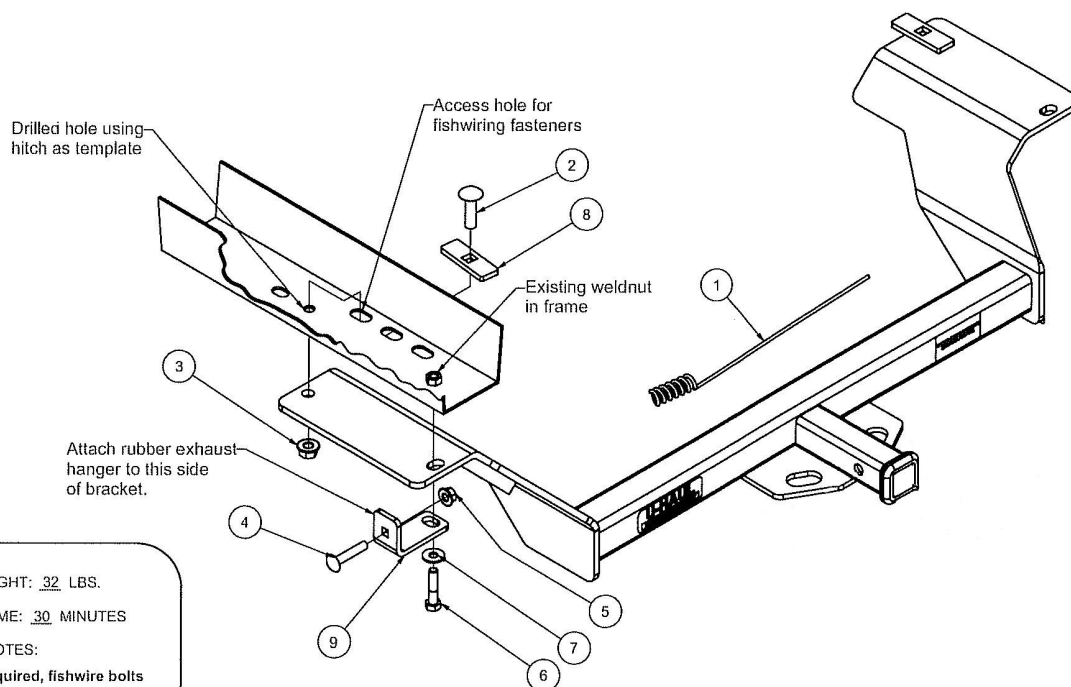

HITCH WEIGHT: 32 LBS.

INSTALL TIME: 30 MINUTES

INSTALL NOTES:

Drilling required, fishwire bolts

INSTALLATION STEPS

- 1) Remove the exhaust hanger bracket from the bottom of the frame rail and disconnect the rubber hanger attached to the exhaust tail pipe. A replacement bracket is provided and will be installed later. Return factory exhaust brackets to the vehicle owner.
- 2) Raise hitch in to position. Using hitch as a template drill two 1/2" holes.
- 3) Lower hitch and fishwire carriage bolts and spacers through frame access holes.
- 4) Attach hanger brackets, install M10 hex bolt thru square hole in bracket to bottom of frame. Slide the rubber hanger onto the 3/8" carriage bolt and secure with flanged hex nut. Tighten nut against the rubber hanger allowing the hanger to rotate. Do not over tighten.
- 5) Torque all M10 fasteners to 53 lb.-ft. Torque all 1/2" fasteners to 75 lb.-ft.

PERIODICALLY CHECK THIS RECEIVER HITCH TO INSURE THAT ALL FASTNERS ARE TIGHT AND THAT ALL STRUCTURAL COMPONENTS ARE SOUND.

Curt Manufacturing Inc., warrants this product to be free of defects in material and/or workmanship at the time of retail purchase by the original purchaser. If the product is found to be defective, Curt Manufacturing Inc. may repair or replace the product, at their option, when the product is returned, prepaid, with proof of purchase. Alteration to, misuse of, or improper installation of this product voids the warranty. Curt Manufacturing Inc.'s liability is limited to repair or replacement of products found to be defective, and specifically excludes liability for incidental or consequential loss or damage.